



New Technoma (India)

SOIL INVESTIGATOR PILLING EXPERT & CIVIL CONSTRUCTION

2 NO CHANDIGARH MAIN ROAD, MADHYAMGRAM, KOL-700130

L.R. PLOT NO.- 16, 17, 19; WARD NO.- 11, J. L. NO. - 228, MOUZA- KHUDSOLE,
P.S.+ DIST.- BANKURA, UNDER BANKURA MUNICIPALITY

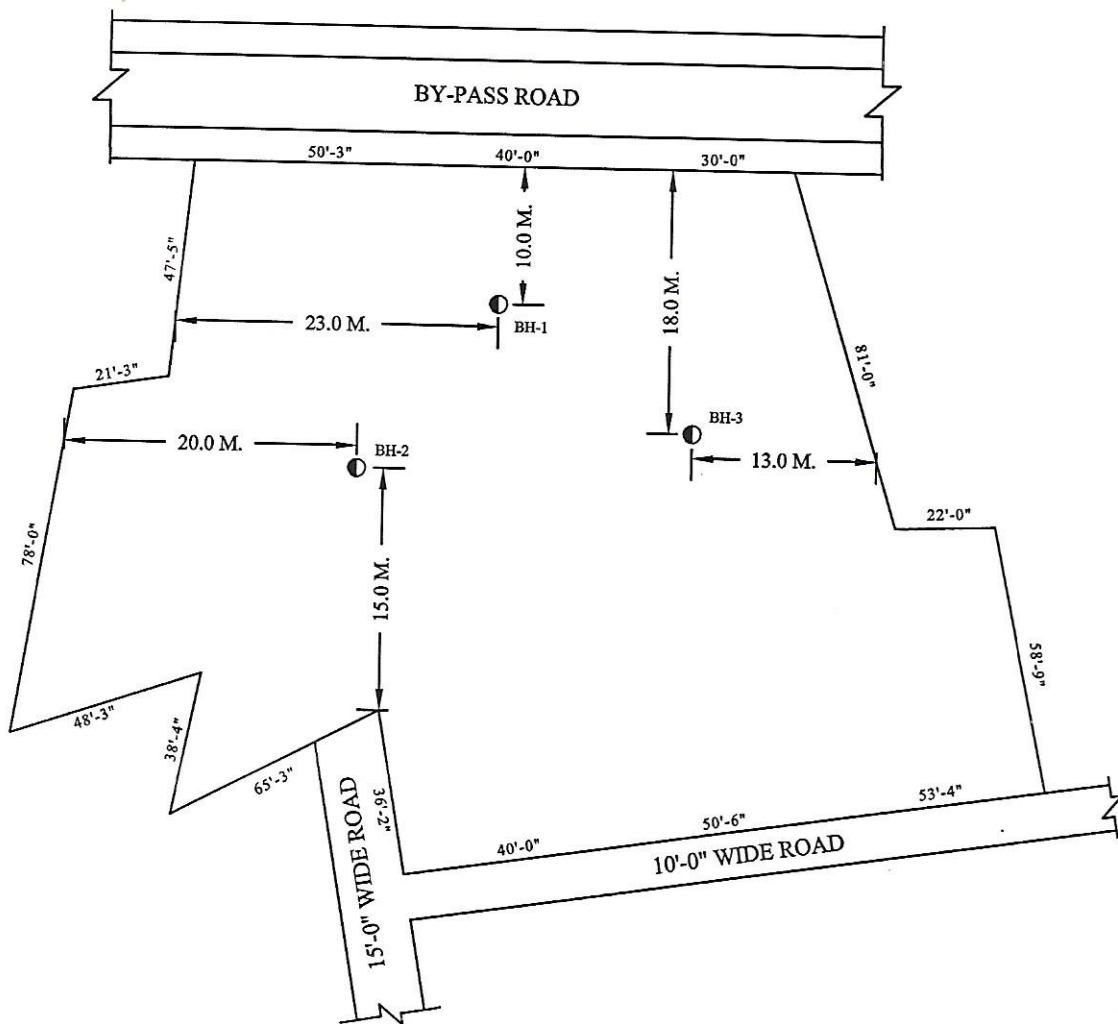

SITE PLAN
NOT TO SCALE

MOB.: 9830554858, 9830565858, 9830411282



New Technoma (India)

SOIL INVESTIGATOR PILLING EXPERT & CIVIL CONSTRUCTOR

2, CHANDIGARH MAIN ROAD, MADHYAMGRAM, KOL - 700130

Project: L. R. Plot No.- 16, 17, 19
Khudsole, Bankura

Page - 11

Alternative Foundation System

BEARING CAPACITY TABLE FOR RAFT FOUNDATION

TYPE OF FOOTING	DEPTH OF FOOTING [M]	NET ALLOWABLE BEARING CAPACITY OF SOIL [T/M ²]	ESTIMATED SETTLEMENT [MM]
RAFT FOUNDATION OF 26.0 M X 51.5 M SIZE	2.90	10.5	100.0

- Note: 1. Depth of foundation is considered at 2.90 m below existing G. L.
2. Permissible settlement of footing is 100 mm.
3. No. of boreholes, explored, are three.

For, NEW TECHNOMA (INDIA)

[BISWANATH MUKHERJEE]
PROPRIETOR

CONSULTING GEOTECHNICAL ENGINEER
[TUSHARBARAN PAHARI]
M. E. (STRUCTURE), AMIE,
MEMBER OF THE INDIAN
GEOTECHNICAL SOCIETY,
CHARTERED ENGINEER
Empanelled Structural Engineer of the Kolkata
Municipal Corporation and HIDCO, New Town